

Plotting Date: 2/18/2025

INDEX OF SHEETS

- Sheet No. 1: Title Sheet
- Sheet No. 2-5: Estimate of Quantities and Environmental Commitments
- Sheet No. 6-10: General Notes and Tables
- Sheet No. 11: Typical Grading Sections
- Sheet No. 12: Traffic Control
- Sheet No. 13: Erosion and Sediment Control Plan
- Sheet No. 14-17: Storm Water Pollution Protection Plan (SWPPP)
- Sheet No. 18: Horizontal Alignment & Control Data
- Sheet No. 19-20: Plan and Profile Sheets
- Sheet No. 21: Easement Plan
- Sheet No. 22: Removal Plan
- Sheet No. 23: Pavement Marking Layout
- Sheet No. 24-27: Standard Plates
- Sheet No. 28-31: Structure Sheets
- Sheet No. 32-33: Cross Sections

PLANS FOR PROPOSED
BR 2025-1 BRIDGE REPLACEMENT
Str. No. 52-511-280 (Highway 14/16)
PENNINGTON COUNTY
 STRUCTURE REPLACEMENT AND APPROACH GRADING

Plot Scale - 1:8000

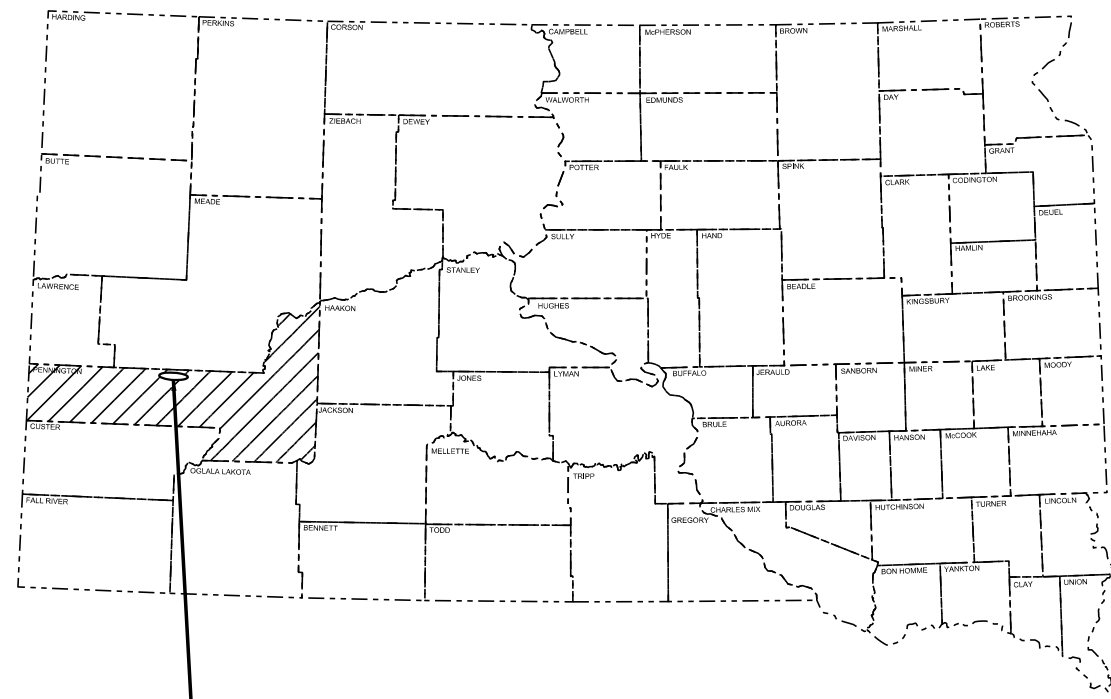

PROJECT

DESIGN DESIGNATION

AA DT (2022)	1552
AA DT (2042)	2543
D	50%
T ADT	14.0%
V	55 mph

STORM WATER PERMIT

Major Receiving
 Body of Water: Tributary to Box Elder Creek
 Area Disturbed: 0.31 Acres
 Total Project Area: 1.79 Acres
 Approx. Begin Lat,Long: 44.11105, -103.03044

Gross Length	110 Feet	0.021 Miles
Length of Exceptions	0.00 Feet	0.000 Miles
Net Length	110 Feet	0.021 Miles

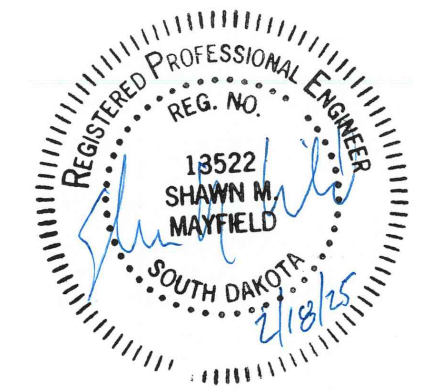
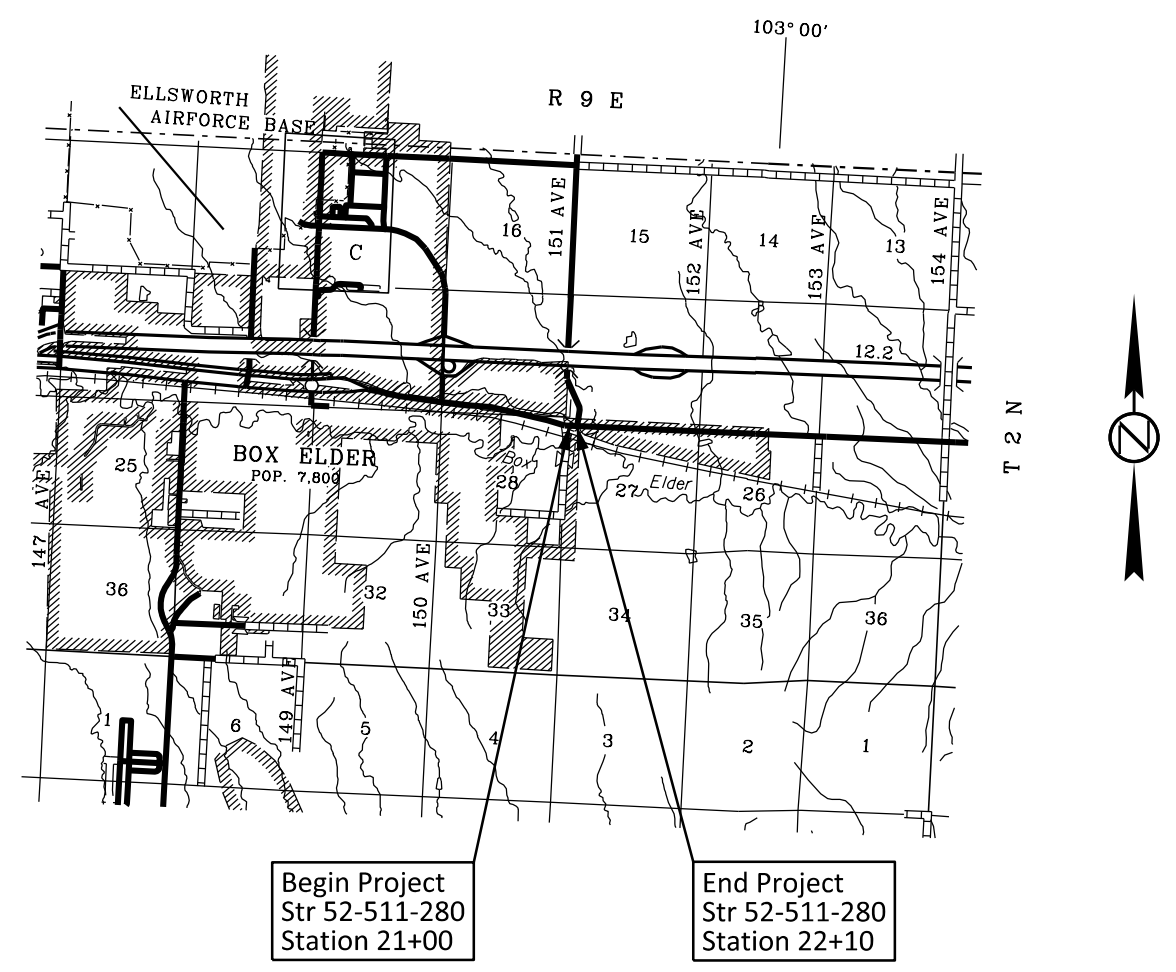

Plotted From - Andrew Kreis

File - ...101_Title Sheet_511.dgn