

Plotting Date: 7/10/2024

PLANS FOR PROPOSED

# PROJECT BRO-B 8052(77) HAMMERQUIST ROAD PENNINGTON COUNTY

STRUCTURE REPLACEMENT AND APPROACH GRADING  
PCN 08N3

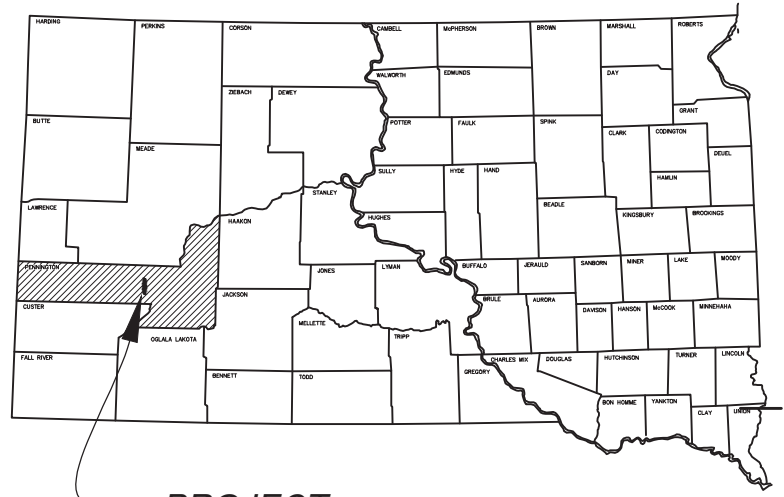

PROJECT

INDEX OF SHEETS

SHEET	TITLE SHEET
1	TITLE SHEET
2-5	ESTIMATE OF QUANTITIES AND ENVIRONMENTAL COMMITMENTS
6-9	GENERAL NOTES AND TABLES
10	TYPICAL GRADING SECTIONS
11	TRAFFIC CONTROL
12	EROSION AND SEDIMENT CONTROL PLAN
13-16	STORM WATER POLLUTION PROTECTION PLAN (SWPPP)
17	HORIZONTAL ALIGNMENT DATA
18	CONTROL DATA
19	LEGEND
20	PLAN AND PROFILE SHEETS
21-22	EASEMENT PLAN
23	REMOVAL PLAN
24-27	STANDARD PLATES
28-43	PRESTRESSED I-GIRDER BRIDGE PLANS
44-45	CROSS SECTIONS

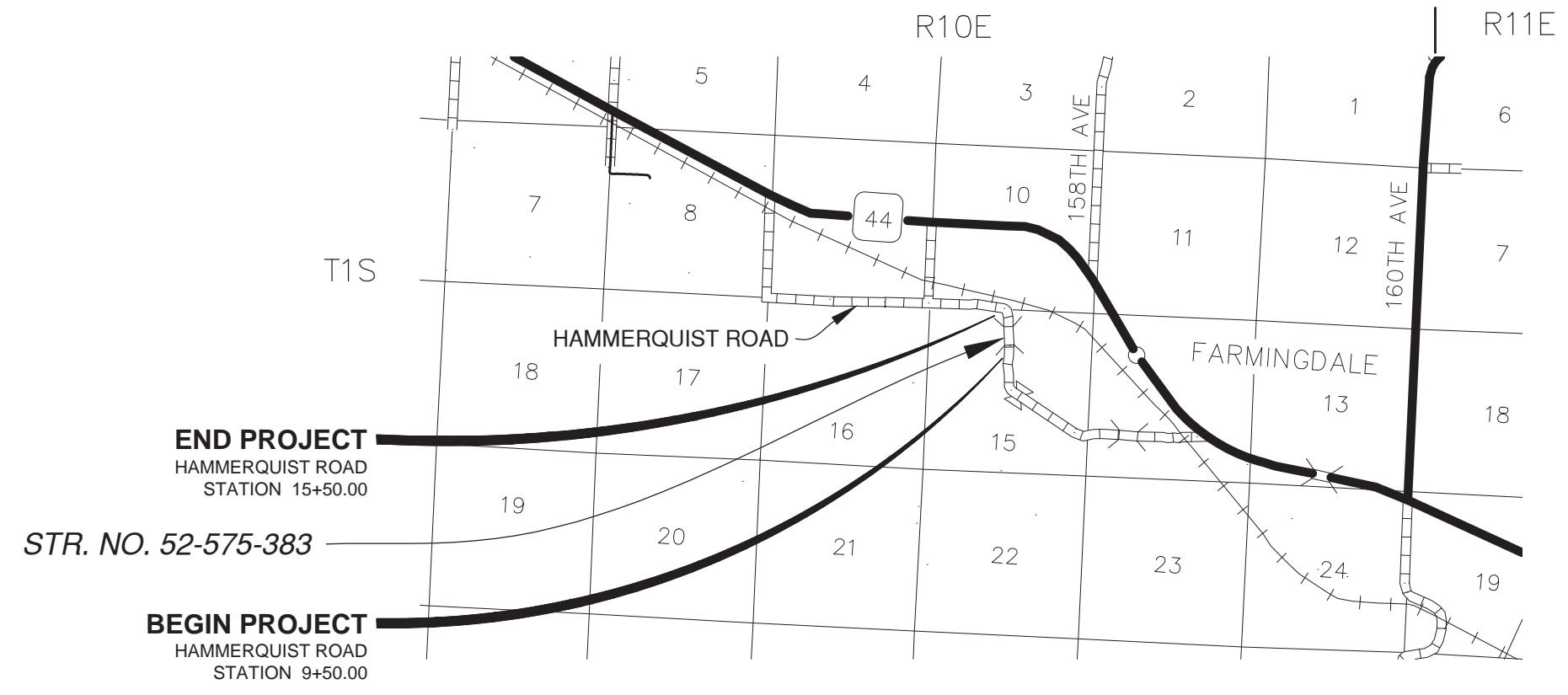

DESIGN DESIGNATION

AADT (2017) 54  
V (Design) 50 mph

STORM WATER PERMIT

Major Receiving Body of Water: Rapid Creek  
Area Disturbed: 0.68 Acres  
Total Project Area: 0.68 Acres  
Approx. Begin Lat,Long: 43°, 58', 1" N - 102°, 54', 33" W (Google Earth)

Gross Length	600 Feet	0.114 Miles
Length of Exceptions	0 Feet	0 Miles
Net Length	600 Feet	0.114 Miles

# 3

October 16, 2024

Plotting Date: 9/19/2024

PLANS FOR PROPOSED

# PROJECT BRO-B 8052(76) THUNDERHEAD FALLS ROAD PENNINGTON COUNTY

STRUCTURE REPLACEMENT AND APPROACH GRADING  
PCN 08N2

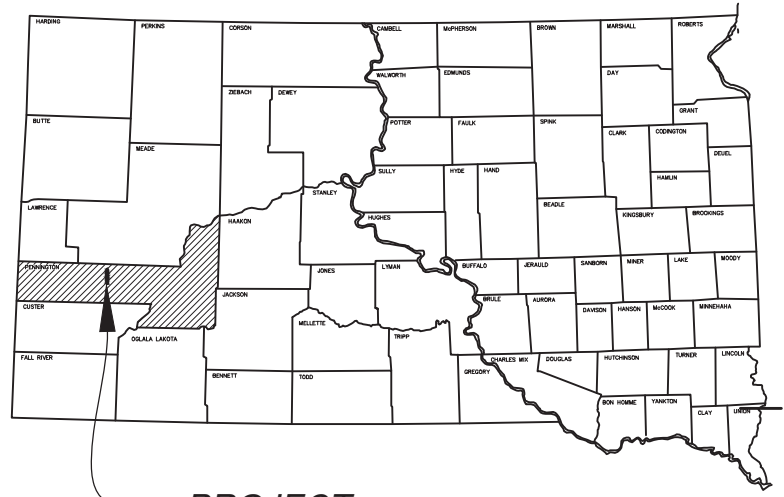

PROJECT

INDEX OF SHEETS

SHEET	TITLE SHEET
1	TITLE SHEET
2-5	ESTIMATE OF QUANTITIES AND ENVIRONMENTAL COMMITMENTS
6-11	GENERAL NOTES AND TABLES
12	TYPICAL GRADING SECTIONS
13	TRAFFIC CONTROL
14	EROSION AND SEDIMENT CONTROL PLAN
15-18	STORM WATER POLLUTION PROTECTION PLAN (SWPPP)
19	HORIZONTAL ALIGNMENT DATA
20	CONTROL DATA
21	LEGEND
22-23	PLAN AND PROFILE SHEETS
24	EASEMENT PLAN
25	REMOVAL PLAN
26	PAVEMENT MARKING LAYOUT
27-32	STANDARD PLATES
33-45	CONCRETE RIGID FRAME BRIDGE PLANS
46-47	CROSS SECTIONS

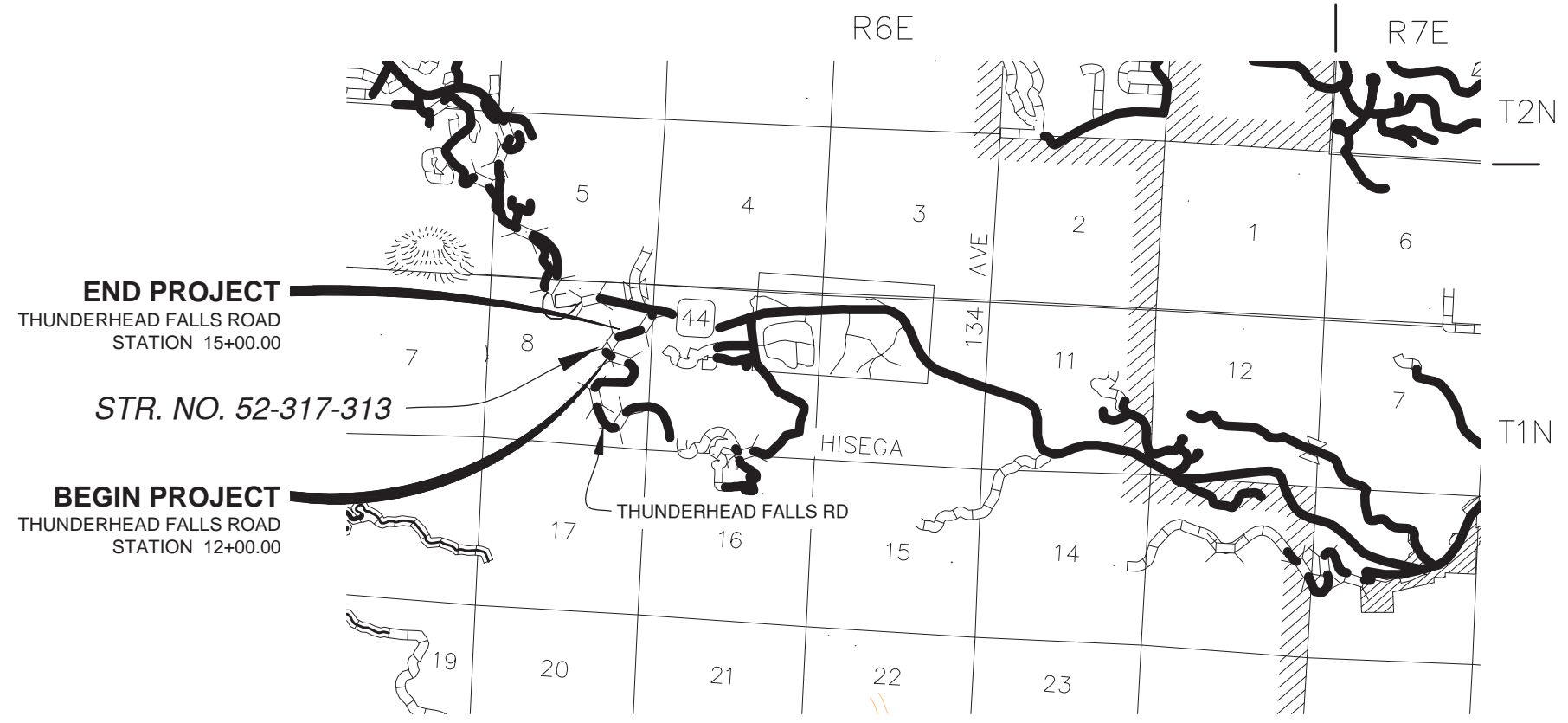

DESIGN DESIGNATION

ADT (2022)	218
ADT (2042)	258
DHV	37
d	50%
T DHV	2.9%
T ADT	4.3%
V	25 mph

STORM WATER PERMIT

Major Receiving	Rapid Creek
Body of Water:	0.54 Acres
Area Disturbed:	0.54 Acres
Total Project Area:	0.54 Acres
Approx. Begin Lat,Long:	44°, 3', 44" N - 103°, 25', 5" W (Google Earth)

Gross Length	300 Feet	0.057 Miles
Length of Exceptions	0 Feet	0 Miles
Net Length	300 Feet	0.057 Miles

# 3

January 22, 2025

Plotted From- zach.vlamnick

File- K:\Projects\State\SD\DOT\102\_00971\_Thunderhead\_Falls\CAD\Design\Plans\Sections\102-00971\_Title Sheet.dwg