

LOCATION MAPS

ASC 2024 ASPHALT SURFACE CRACK SEALING

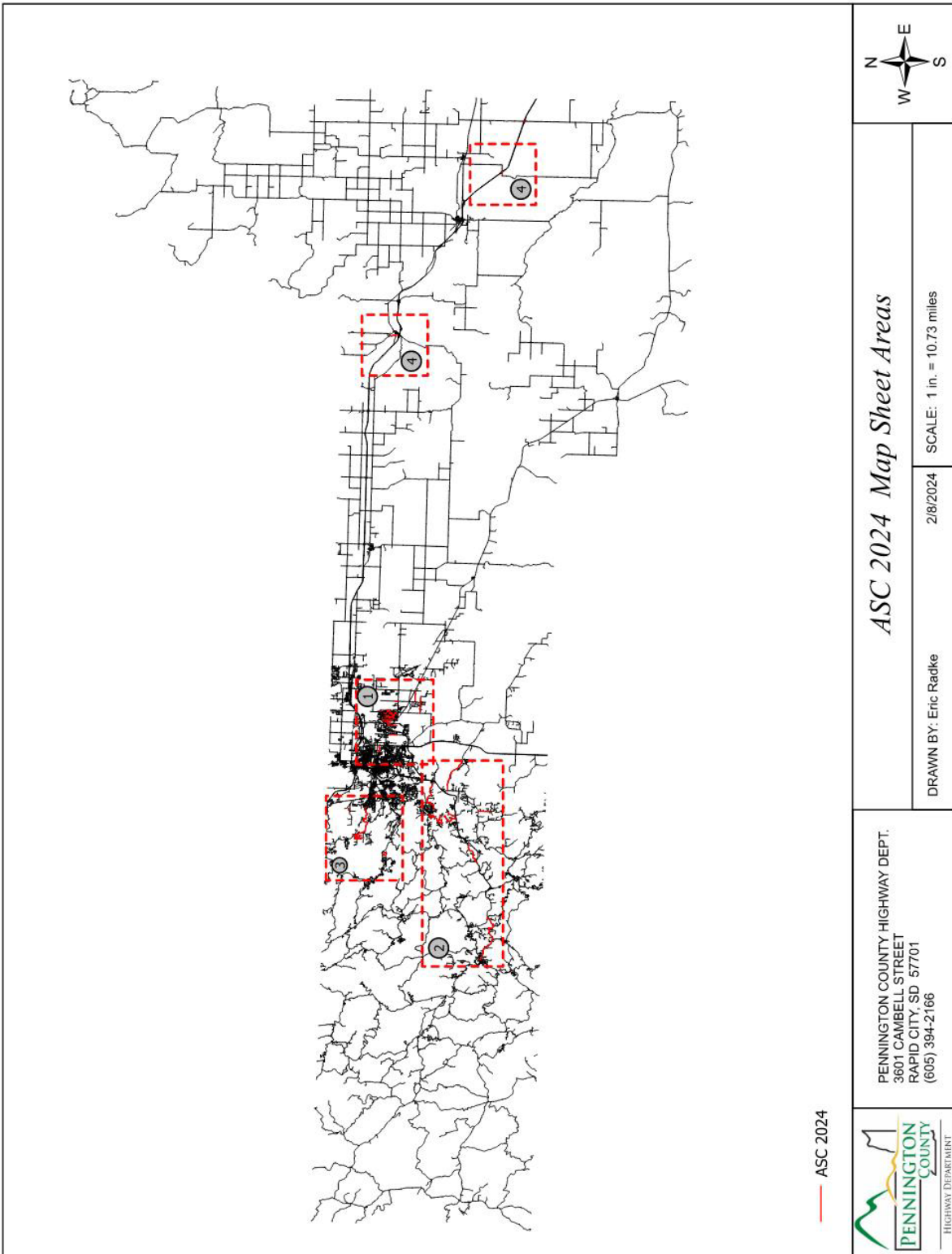

LOCATION MAPS (CONTINUED)

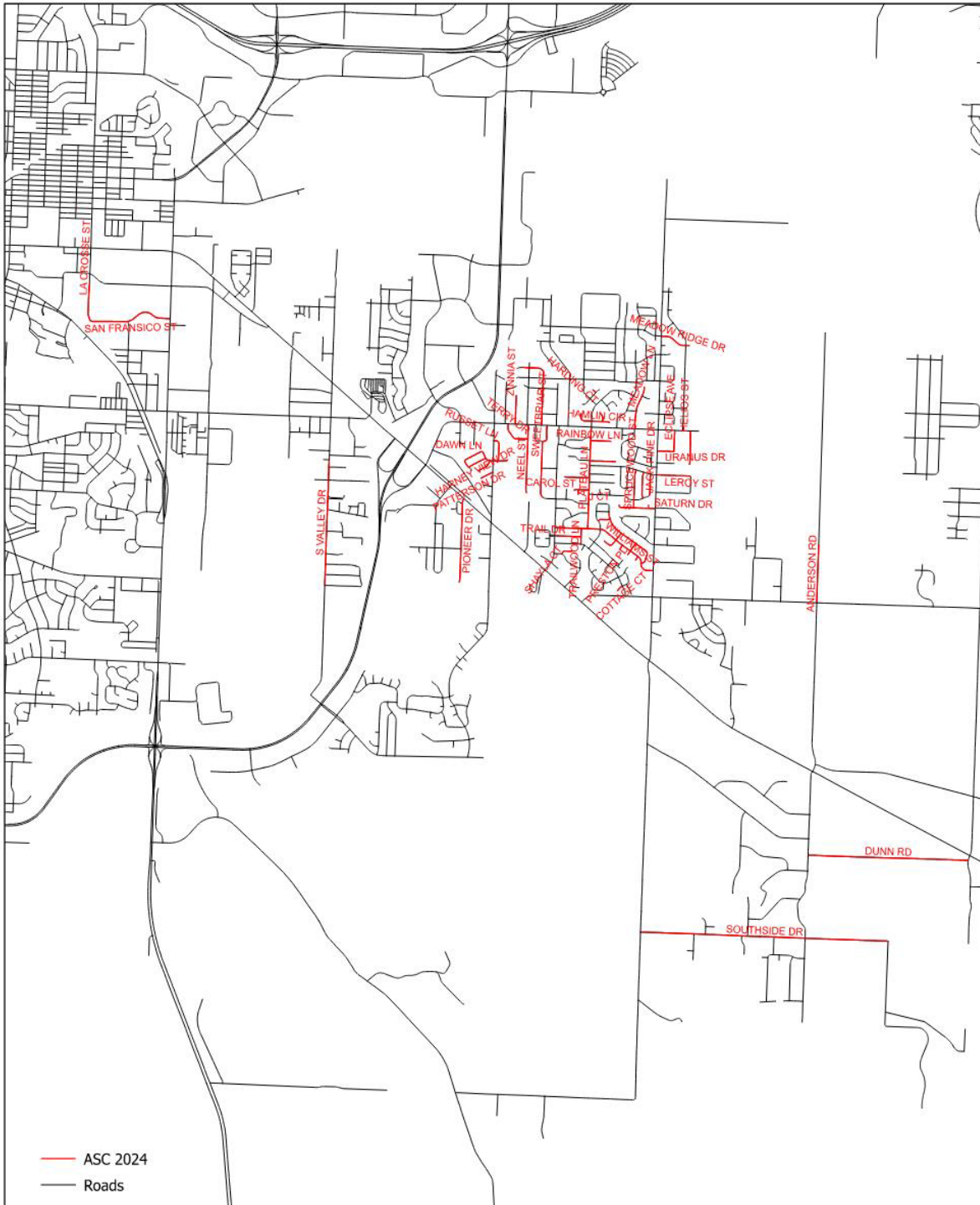

— ASC 2024
 — Roads



PENNINGTON COUNTY HIGHWAY DEPT.
 3601 CAMBELL STREET
 RAPID CITY, SD 57701
 (605) 394-2166

ASC 2024 (Area 1)

DRAWN BY: Eric Radke 2/8/2024 SCALE: 1in = 0.75



LOCATION MAPS (CONTINUED)

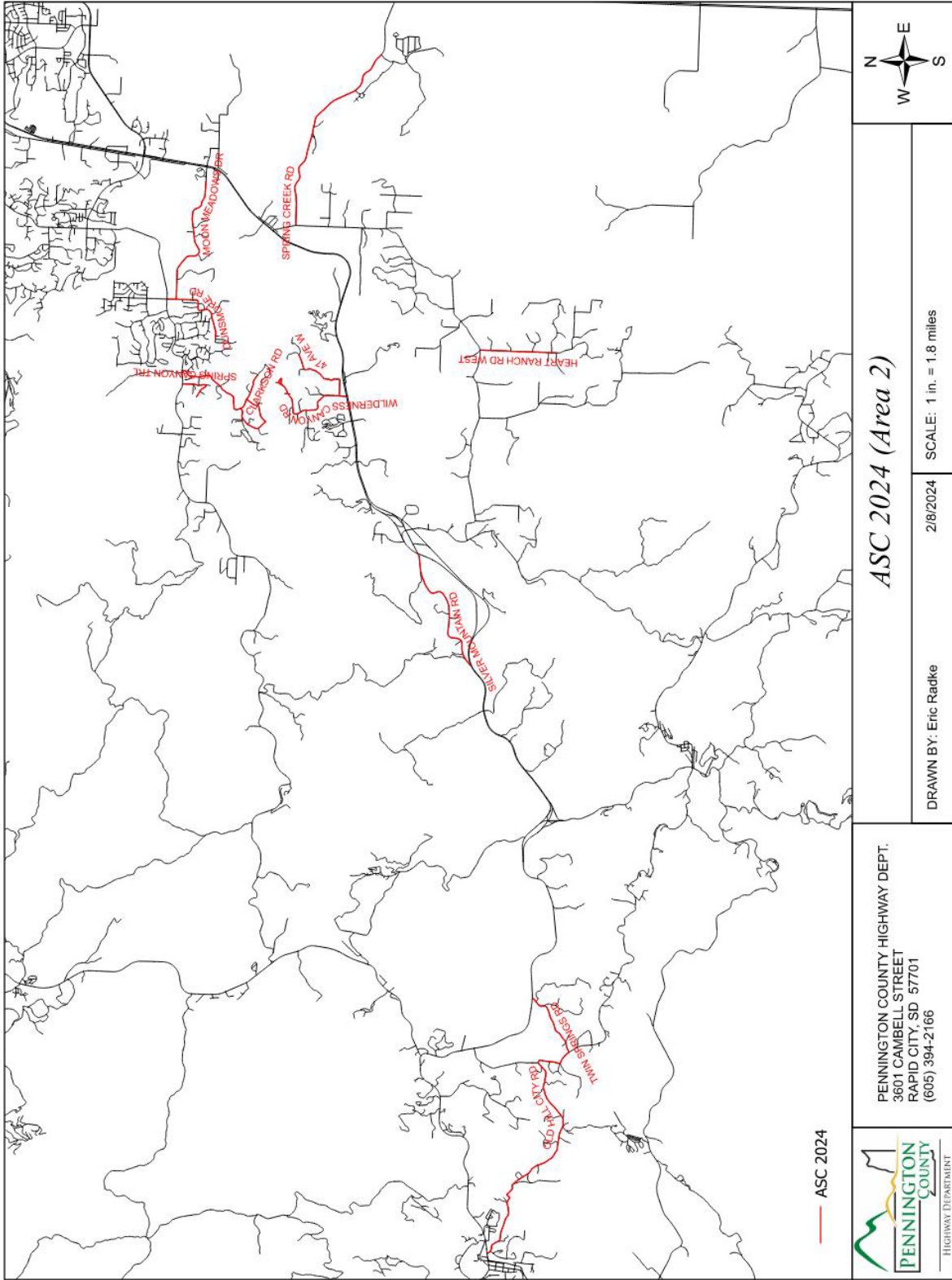

PENNINGTON COUNTY HIGHWAY DEPT.
3601 CAMBELL STREET
RAPID CITY, SD 57701
(605) 394-2166

ASC 2024 (Area 2)

DRAWN BY: Eric Radke

2/8/2024

SCALE: 1 in. = 1.8 miles



LOCATION MAPS (CONTINUED)

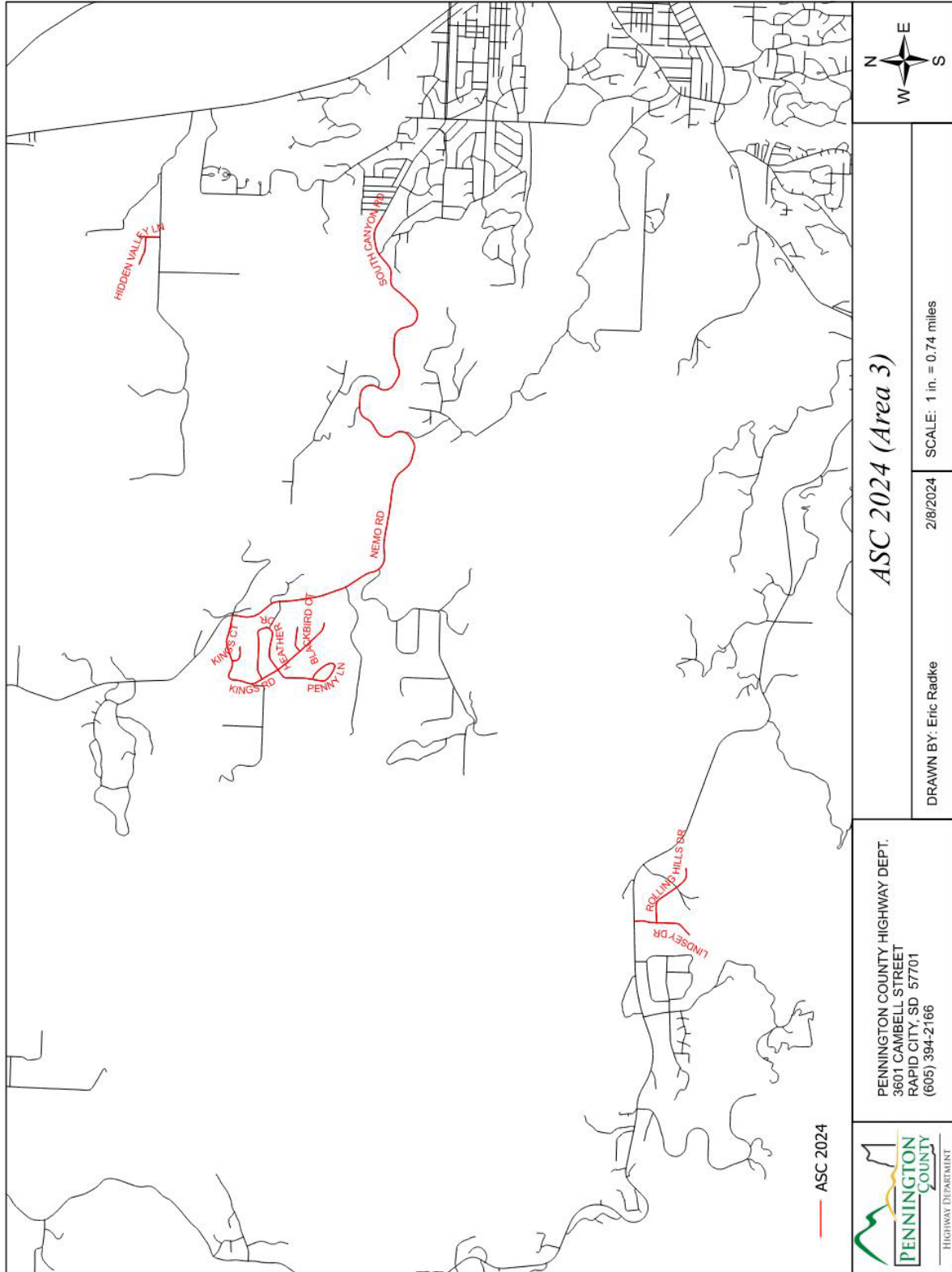

LOCATION MAPS (CONTINUED)

